

Most items are UL, UR and CSA.



Stock Number	Style	Mounting Pins	Use With Socket	Form	Operating Current	AC Coil Ratings are	Coil Current	AA Electric Model	Mechanical Operator & Indicator	Price
0401050	A	8	OC0470	DPDT	10A	24 VAC	84 MA	A204M	YES	\$7.20
0401100	A	8	OC0470	DPDT	10A	120 VAC	17.5 MA	A201M	YES	\$7.20
0401150	A	8	OC0470	DPDT	10A	240 VAC	8.8 MA	A205M	YES	\$8.45
0401200	A	11	OC0475	3PDT	10A	24 VAC	84 MA	A304M	YES	\$8.35
0400250	A	11	OC0475	3PDT	10A	120 VAC	17.5 MA	A301M	YES	\$8.35
0401450	A	11	OC0475	3PDT	10A	240 VAC	8.8 MA	A305M	YES	\$10.55
0401300	A	8	OC0470	DPDT	10A	24 VDC	51 MA	D204M	YES	\$7.20

8

Call for Quantity Pricing and Other Types of Relays.



Stock Number	Style	Mounting Pins	Use With Socket	Form	Operating Current	AC Coil Ratings are	Coil Current	Omron Model LY	Price
OC05170	B	8	OC1033	DPDT	10A	24 VAC	46 MA	2AC24	\$4.50
OC05150	B	8	OC1033	DPDT	10A	120 VAC	9.2 MA	2AC120	\$4.50
OC05190	B	8	OC1033	DPDT	10A	24 VDC	36.9 MA	2DC24	\$4.50
								MY	
OC05100	C	14	OC0485	4PDT	5A	24 VAC	46 MA	4AC24	\$4.50
OC05400	C	14	OC0485	4PDT	5A	24 VDC	36.9 MA	4DC24	\$4.50
OC10400	C	14	OC0485	4PDT	5A	120 VAC	9.2 MA	4AC120	\$4.50

FOR ADDITIONAL VOLTAGES AND STYLES CALL **1-800-237-8274** PRICES SUBJECT TO CHANGE

DIN RAIL (Available in Custom Cut Lengths)

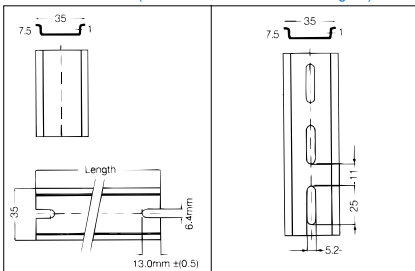

Stock #9073050-\$4.00
Non-Perforated Aluminum
DIN RAIL, 3 Feet

Stock #9073070-\$9.18
Perforated Steel
DIN RAIL, 6 Feet

SOCKETS

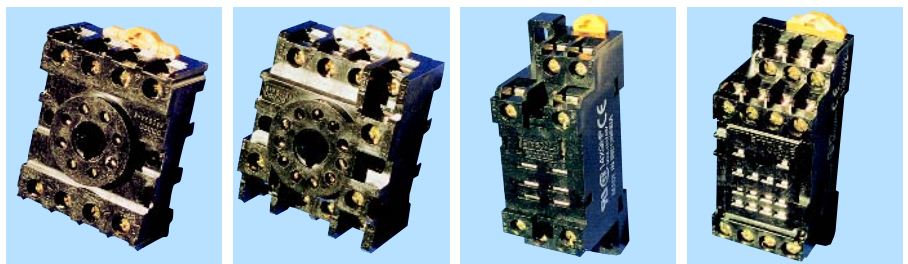

Stock #OC04700-\$2.20
Omron Surface or Track Mounted Socket
PF083A-E

(Conforming to DIN EN 50022)

Stock #OC04750-\$3.50
Omron Surface or Track Mounted Socket
PF113A-E

(Conforming to DIN EN 50022)

Stock #OC10330-\$2.75
Omron Surface or Track Mounted Socket
PTF08A-E

Stock #OC04850-\$3.50
Omron Surface or Track Mounted Socket
PYF14A-E



AAE Series Medium Power Plug-in Relays

Features

- Low Cost
- Rugged Design
- 10 Amp Output
- High Reliability
- 8 Pin on 11 Pin Plug-in Base
- DPDT and SPDT Arrangements
- 12, 24, 120 & 240 Volts Operation

Most Models

Relays from
\$5.08 each
 (100 piece)

Sockets from **\$2.20**

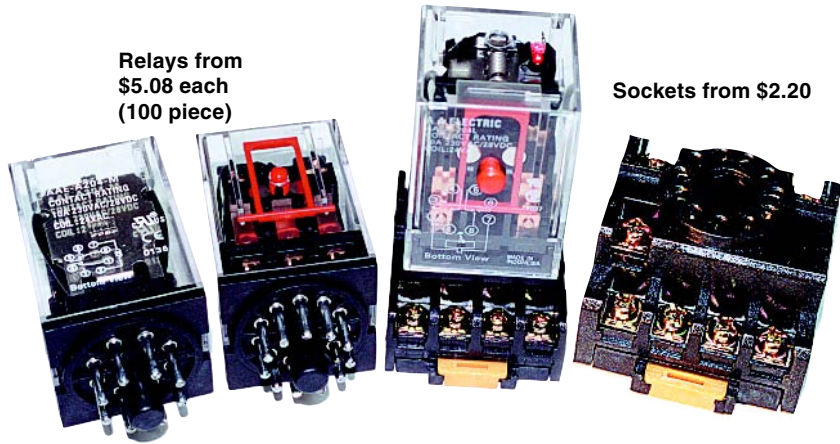

Specifications

Control Voltage	12 to 240 VAC and 12 to 110 VDC, See Table 1
Pick-Up Voltage	80% of Nominal
AC Coils	80% of Nominal
DC Coils	80% of Nominal
Drop-Out Voltage	30% Nominal
AC Coils	30% Nominal
DC Coils	10% Nominal
Maximum Voltage	110% of Nominal
Response Time	30 m. seconds, maximum
Pick-Up	30 m. seconds, maximum
Drop-Out	30 m. seconds, maximum
Temperatures	
Operate	-10°C to +40°C
Storage	-45°C to + 85°C
Power (Nominal Voltage)	
AC Coils	2.1 VA
DC Coils	1.2 Watts
Duty Cycle	Continuous
Insulation Resistance	100 Meg ohms, minimum
Dielectric Strength	1500 VAC 50/60 Hz for 1 min.
Contact Material	Silver cadmium oxide
Contact Arrangements	
DPDT	8 pin plug-in
3PDT	11 pin plug-in
Output Ratings	See Table 2

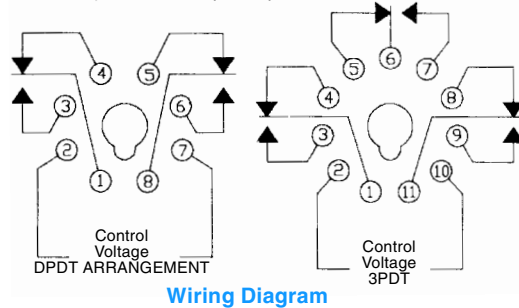
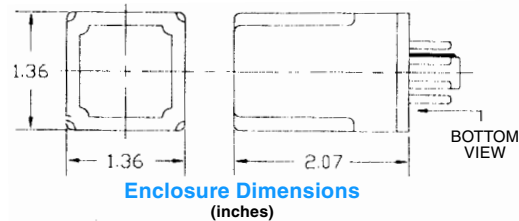

Order Information

AAE	
Type of Voltage	Indicators
A = AC	M = Mechanical Indicator & Push-to Test
D = DC	L = Lamp
Contact Arrangement	Control Voltage
2 = DPDT	01 = 120 Volts
3 = 3PDT	12 = 12 Volts
	04 = 24 Volts
	05 = 240 Volts

Example: AAE A 2 01 L

Socket for Track or Surface Mount
 DPDT 8 Pin = NDS-8 **\$2.20**
 3PDT 11 Pin = NDS-11 **\$3.50**

Din Rail

(Available in Custom Cut Lengths)

Stock #9073050 **\$4.00** Non-Perforated Aluminum Din Rail, 3 Feet

Stock #9073070 **\$9.18** Perforated Steel Din Rail, 6 Feet

Table 1 Coil Ratings

Nominal Voltage		Rated Current (mA)		Coil Resistance (Ohms)
		50 Hz	60 Hz	
AC	12	199	168	-
	24	99	84	
	240	10.2	8.8	
DC	12	100	120	-
	24	51	472	
	110	11.5	10,000	

Table 2 Output Contact Ratings

Specifications	Resistive Load (p.f. = 1)	Inductive Load (p.f. = 0.4) L/R=7msec
Rated Load	230 VAC 10A 28 VDC 10A	230 VAC 6A 28 VDC 7.5A
Carry Current	10A	
Max. Operating Voltage	500 VAC 250 VDC	
Max. Operating Current	10A	
Max. Switching Capacity	2300VA 280W	1400VA 210W
Minimum Permissible Load	5 VDC 100mA	

Relays from \$6.05

Most Models

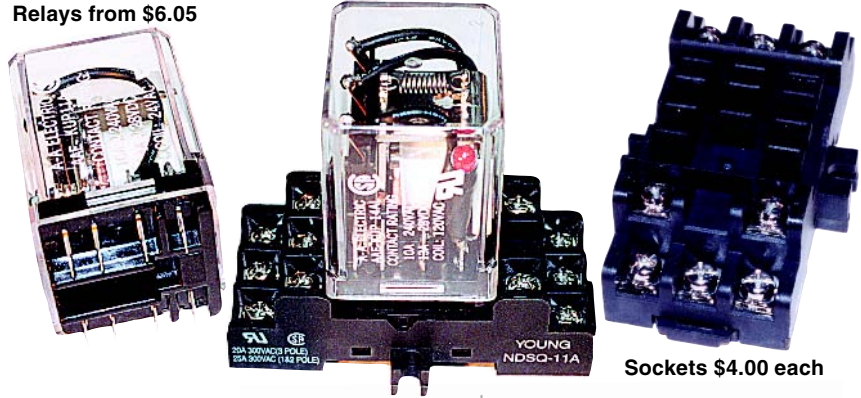

Sockets \$4.00 each

Features

- Low Cost
- Rugged Design
- 10 Amp Output
- High Reliability
- Blade Type Plug-in Base
- DPDT and 3PDT Arrangements
- 12, 24, 120 & 240 Volts Operation

Specifications

Control Voltage	12 to 240 VAC and 12 to 110 VDC, See Table 3
Pick-Up Voltage	
AC Coils	80% of Nominal
DC Coils	80% of Nominal
Drop-Out Voltage	
AC Coils	30% Nominal
DC Coils	10% Nominal
Maximum Voltage	110% of Nominal
Response Time	
Pick-Up	30 m. seconds, maximum
Drop-Out	30 m. seconds, maximum
Temperatures	
Operate	-10°C to +40°C
Storage	-45°C to +85°C
Power (Nominal Voltage)	
AC Coils	2.1 VA (3PDT -2.5VA)
DC Coils	1.2 Watts
Duty Cycle	Continuous
Insulation Resistance	100 Meg ohms, minimum
Dielectric Strength	2000 VAC 50/60 Hz for 1 min.
Contact Material	Silver cadmium oxide
Contact Arrangements	
DPDT	8 pin plug-in
3PDT	11 pin plug-in
Output Ratings	See Table 4

Enclosure Dimensions (inches)

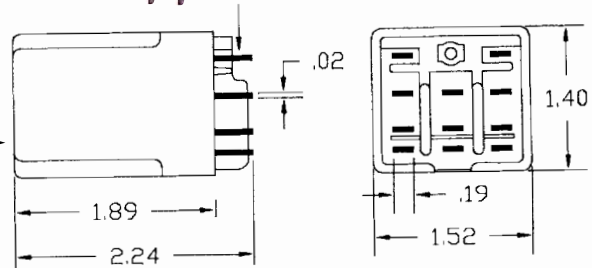

Wiring Diagram

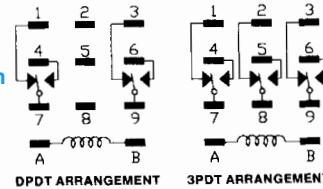

Order Information

AAE-KUP

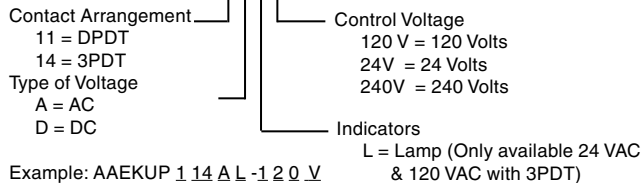

Socket for Track or Surface Mount NSDQ-11 \$4.00

Din Rail

(Available in Custom Cut Lengths)

Stock #9073050 \$4.00 Stock #9073070 \$9.18
 Non-Perforated Aluminum Perforated Steel
 Din Rail, 3 Feet Din Rail, 6 Feet

Table 3

Contact Arrangement	Nominal Voltage	Rated Current (mA)		Coil Resistance (Ohms)
		50 Hz	60 Hz	
DPDT	AC 12	188	168	-
	24	94	84	
	120	19.6	17.5	
3PDT	AC 12	218	195	-
	24	122	109	
	120	23	20.5	
DPDT 3PDT	DC 12	100	120	470 10,000
	24	51	470	
	110	11	10,000	

Table 4

Specifications	Output Contact Ratings	
	Resistive Load (p.f. = 1)	Inductive Load (p.f. = 0.4) L/R=7msec
Rated Load	110 VAC 10A 24 VDC 10A	110 VAC 7A 24 VDC 7A
Carry Current	10A	
Max. Operating Voltage	500 VAC 250 VDC	
Max. Operating Current	10A	7A
Max. Switching Capacity	1600VA 280W	1100VA 200W
Minimum Permissible Load	1 VDC 10mA (Reference Value)	